

SUITABLE FOR MODEL

IMAGE MAY VARY FROM ACTUAL PRODUCT

SAFETY INSTRUCTION**READ CAREFULLY BEFORE INSTALLING FIXTURE. PLEASE KEEP THIS MANUAL FOR FUTURE USE.**

Fixtures must be wired in accordance with the National Electrical Code and all applicable local codes. Proper grounding is required for safety.

THIS PRODUCT MUST BE INSTALLED IN ACCORDANCE WITH THE APPLICATION CODE BY A PERSON FAMILIAR WITH THE CONSTRUCTION AND OPERATION OF THE PRODUCT AND THE HAZARDS INVOLVED. MAKE CERTAIN POWER IS OFF BEFORE INSTALLING OR MAINTAINING FIXTURE.**CHECK THAT VOLTAGE IS COMPATIBLE WITH FIXTURE DRIVER. USE APPROVED CONNECTORS FOR ALL ELECTRICAL CONNECTIONS.****Maintenance Caution****CAUTION:** Be sure fixture temperature is cool enough to touch. Do not clean or maintain while fixture is energized.

1. Clean glass lens & fixture with non-abrasive glass cleaning solution.
2. Do not open fixture to clean the LED. Do not touch the LED.

WIRE CONNECTION

Universal voltage driver permits operation at 120V thru 277V, 50 or 60 Hz.

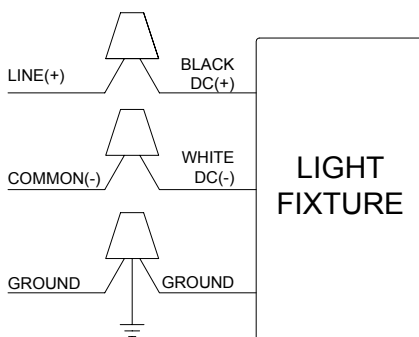

INSTALLATION**WALL MOUNT VERSION**

1. CAUTION – DO NOT TOUCH THE LED.
2. Secure mounting box using two tabs to junction box or wall using appropriate hardware (by others) for the surface. If mounting to a junction box, apply silicon sealant around where mounting box and junction box meet to ensure a watertight seal.
3. Remove four screws holding arm/LED housing assembly to mounting box.
4. Remove silicon rubber gasket to gain access to mounting box.
5. Make electrical connections. Supply wires can be brought into mounting box either through end opening or through conduit into any of four 1/2" threaded hubs. If surface mount conduit is used, apply silicon to ensure a watertight seal.
6. Reinstall silicon rubber gasket to mounting box.
7. Reattach arm/LED housing assembly to mounting box using four screws.
8. Install glass globe onto LED housing until silicon rubber gasket in LED housing is compressed. Do not overtighten.
9. Install die cast guard onto LED housing. Tighten set screw with Allen key.
10. Turn on power.

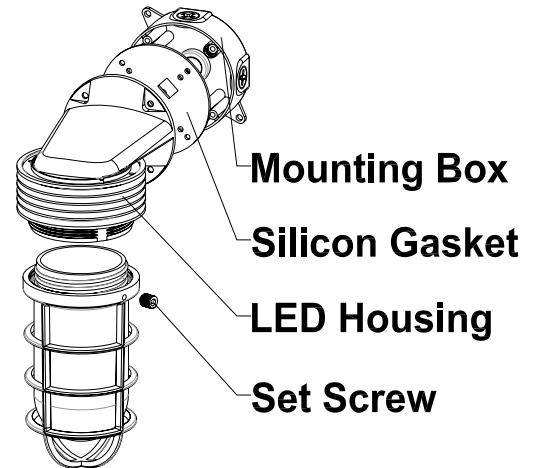
**PENDANT MOUNT VERSION**

1. CAUTION – DO NOT TOUCH THE LED.
2. Mount a pendant to the 1/2" threaded opening in the top of the fixture. Apply silicon sealant for a weatherproof seal.
3. Remove silicon rubber gasket in LED housing to gain access to screws.
4. Completely loosen one screw which is holding LED housing top top housing. The screw will still be held captive by O-ring gasket on screw. Partially loosen second screw. Rotate LED housing on partially loosened screw to get access to the top housing.
5. Make electrical connections.
 - a) Connect hot supply wire to black wire on LED driver.
 - b) Connect neutral supply wire to white wire on LED driver.
 - c) Connect ground supply wire to green ground screw in mounting box.
6. Rotate LED housing back to its original position and tighten both screws. Ensure wires are not pinched when rotating LED housing back.
7. Replace silicon rubber gasket in LED housing.
8. Install glass globe onto LED housing until silicon rubber gasket is compressed. Do not overtighten.
9. Install die cast guard onto LED housing. Tighten set screw with Allen key.
10. Turn on power.

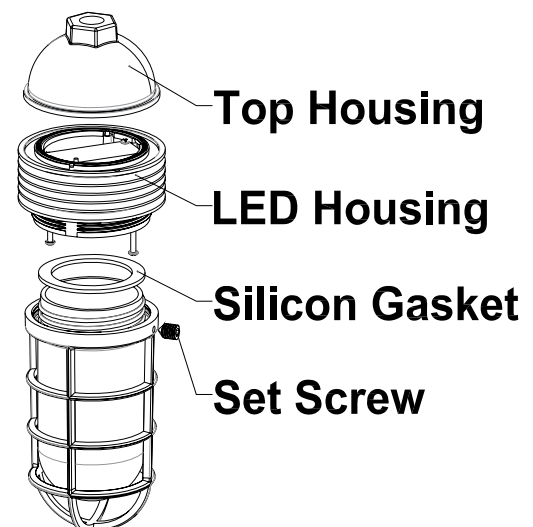

BOX/CEILING MOUNT VERSION

1. CAUTION – DO NOT TOUCH THE LED.
2. Secure mounting box using two tabs to junction box, wall or ceiling using appropriate hardware (by others) for the surface. If mounting to a junction box, apply silicon sealant around where mounting box and junction box meet to ensure a watertight seal.
3. Remove silicon rubber gasket in LED housing to gain access to screws.
4. Completely loosen one screw which is holding LED housing to mounting box. The screw will still be held captive by O-ring gasket on screw. Partially loosen second screw. Rotate LED housing on partially loosened screw to get access to the mounting box.
5. Make electrical connections. Supply wires can be brought into mounting box either through end opening or through conduit into any of four ½" threaded hubs. If surface mount conduit is used, apply silicon to ensure a watertight seal.
 - a) Connect hot supply wire to black wire on LED driver.
 - b) Connect neutral supply wire to white wire on LED driver.
 - c) Connect ground supply wire to green ground screw in mounting box.
6. Rotate LED housing back to its original position and tighten both screws. Ensure wires are not pinched when rotating LED housing back.
7. Replace silicon rubber gasket in LED housing.
8. Install glass globe onto LED housing until silicon rubber gasket is compressed. Do not overtighten.
9. Install die cast guard onto LED housing. Tighten set screw with Allen key.
10. Turn on power.

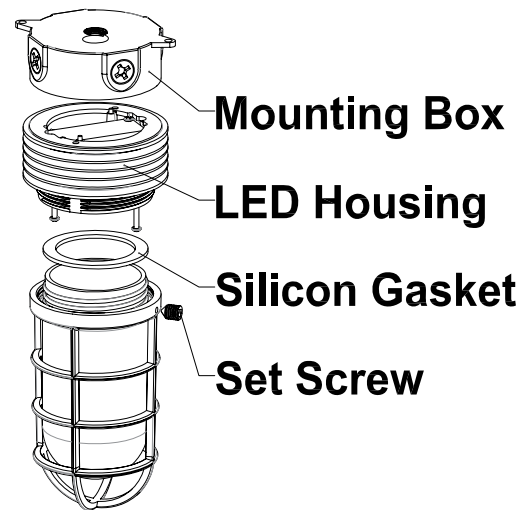

Ref#: 10848-21020